

TUM Campus Taufkirchen/Ottobrunn

TUM Department ASG
25. September 2025 v0.1



Table of contents

1. The Journey and Vision of ASG at TUM – Prof. Chiara Manfletti
2. Overview of the interim campus – Prof. Fernaß Daoud
3. Study spots in campus – Prof. Chiara Manfletti
4. Food – Hafil Mohammed
5. How will the curriculum/schedule be organized? – Dr. Dimitri Franz
6. Mobility – Brigitte Richter

MISSION EARTH

COMPREHENDING OUR WORLD
IS MOVING OUR WORLD



Mission Earth

Cutting-Edge Research, Technological Advancement and Social Responsibility



**Mobility &
Urbanisation**



**Safety &
Security**



**Environment &
Food Production**



**Knowledge &
Passion**



ASG Facts & Figures

(Statistics 2025)



30
Professors



2.000+
Students



400+
Staff Members

4 Locations:
Ottobrunn/Taufkirchen, Garching,
Oberpfaffenhofen, Munich



No. 3 worldwide in Geodesy/Remote
Sensing
No. 32 worldwide in Aerospace Engineering



Global Ranking of Academic Subjects 2024 (Shanghai Ranking)



Current and Planned Professorships

From 30 professorships (2025) to ca. 50 professorships

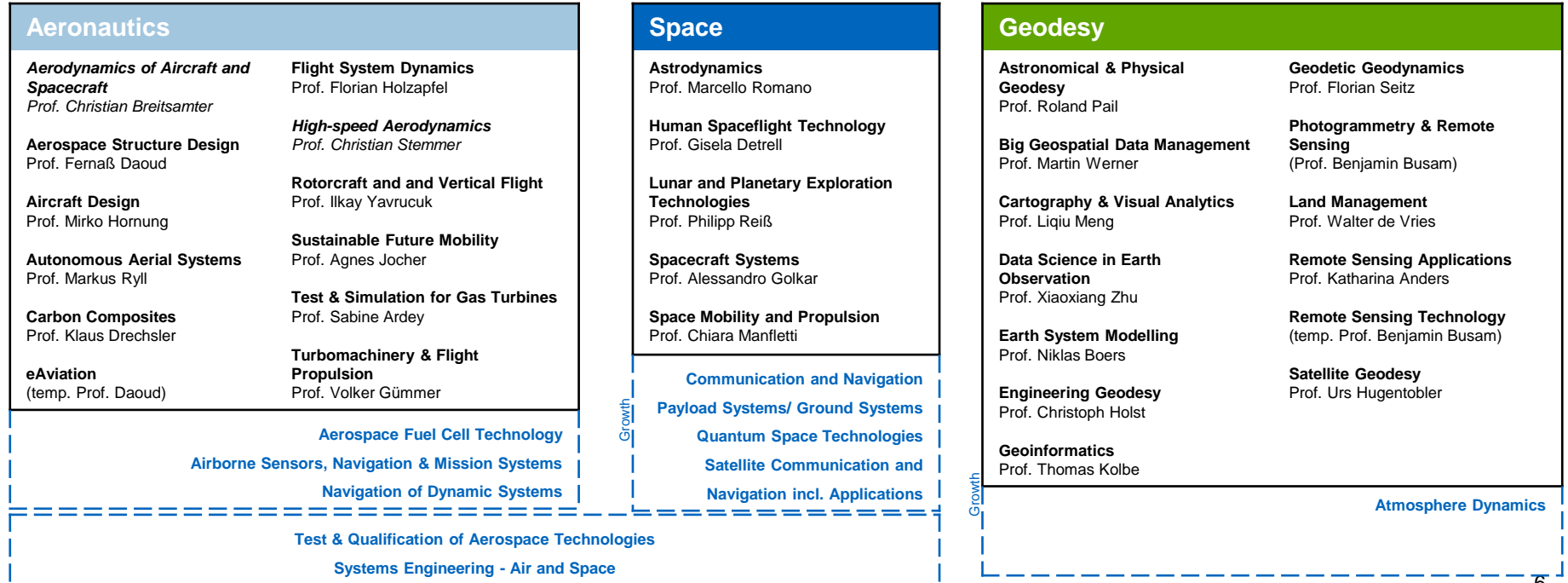



TUM Campus in Taufkirchen/Ottobrunn



TUM Campus in Taufkirchen/Ottobrunn

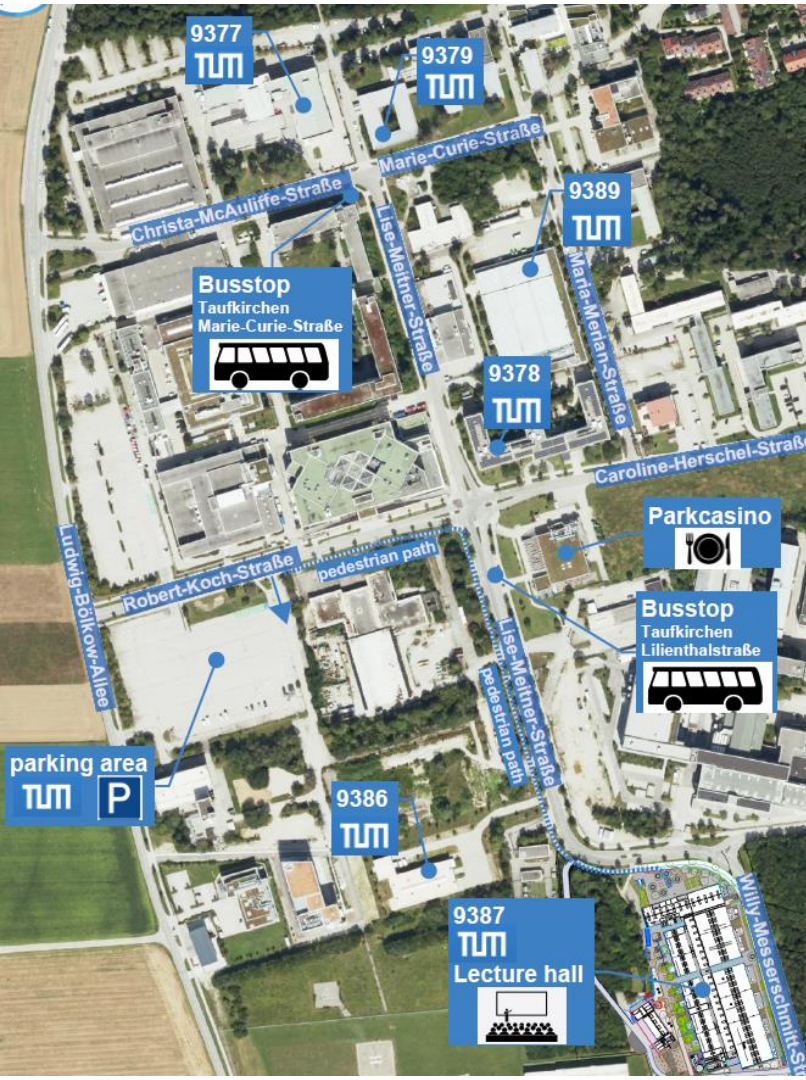

Our upcoming milestones

ASG 2025 – “Groundbreaking”

ASG 2027 – “Next Horizon”

ASG 2035 – “Beyond Boundaries”



ASG 2025 – “Groundbreaking”





ASG 2035 – “Beyond Boundaries”

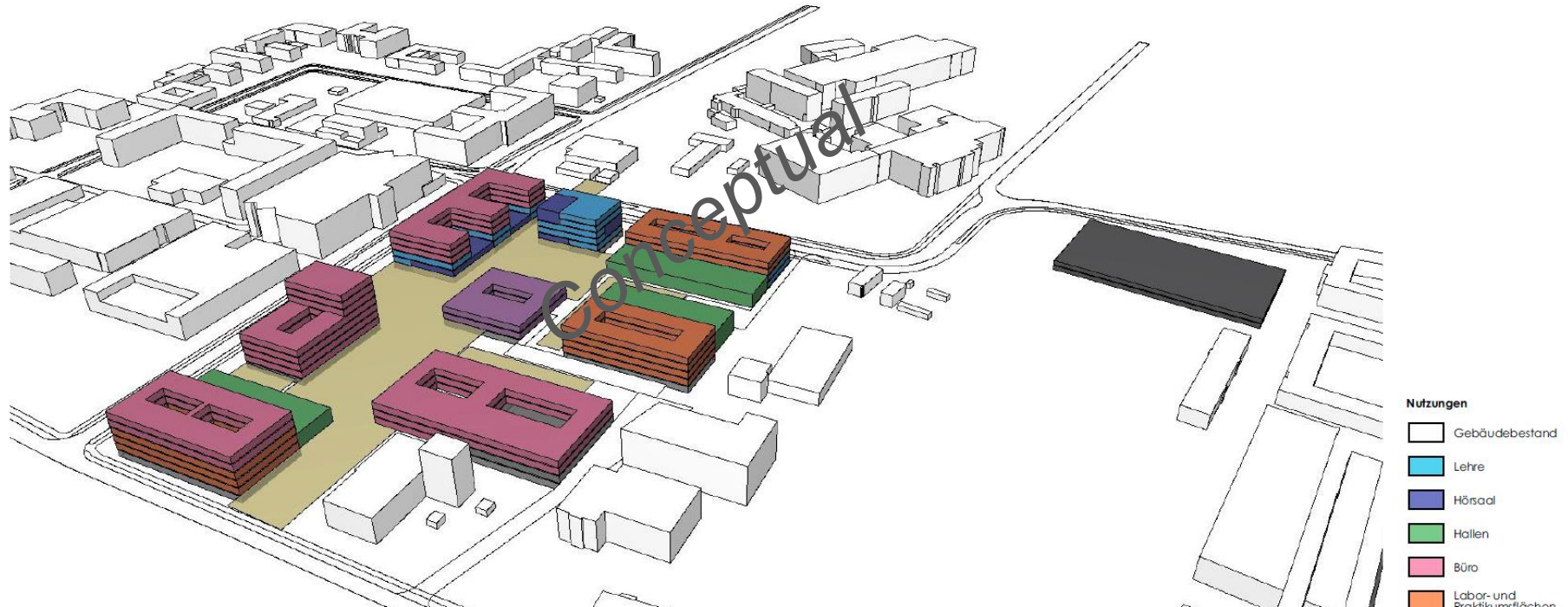



Campus Mission Statement

**Educational
excellence &
innovation**



**Interactive, project-
orientated
learning**



**Excellence in
research**



**Campus life & an
entrepreneurial
ecosystem**



**Warm, sustainable
campus**





**An interactive interconnecting learning
and research environment!**



Welcome to your gateway to the future!





Waiting for YOU!



Overview of the interim building complex

- Total capacity for ~2500 students in the lecture area
- 11 lecture halls with variable seating arrangements and tiered seating (smallest hall with 64 seats and the largest with 820 seats)
- 1 multifunctional room with seating for up to 280 people
- State of the art media technology and acoustic rooms with a single projection in smaller halls and dual projection in the larger lecture halls
- Washrooms are located at the North and South of the building
- 4 washrooms for disabled people which also include the showers



Multifunctional room





Tiered seating





Study spots

In the interim building

- Study tables will be set up in the main hallway of the campus
- There will also be additional seating in the multifunctional room.
- Lecture halls may also be used for studying when unoccupied

Building 9379 (Lise-Meitner-Str. 8)

- 50 seats in group study rooms and 70 seats in the silent rooms for individual work will be made available

Library

- The library will begin construction this semester and be open by WiSe 26/27

Food

Park Casino

- As the mensa will only open by WiSe 26/27, we are collaborating with Park Casino in Ottobrunn to provide meals for TUM Students & Employees at a **discounted price during the lecture period.**
- Café opening hours: 07:30 - 14:00
- Casino opening hours: 11:00 - 13:30
- Reduced prices for Students/Staff:
 - Main course (vegan/vegetarian): 4,15 €
 - Main course (Bavarian classics): 5,35 €
 - Main course (international classics): max 7,75 €
 - Soup of the day: 0,95 €
 - Salads: from 1,40 €
 - Desserts: from 1,10 €
 - Drinks: from 0,20 €

**You may download the
WISAG catering app for the
daily menu and allergen
information.**

Food

CaterCards at Park Casino

- Students/Staff must purchase a CaterCards to access the reduced prices during the semester which can be bought and topped up using Credit/Debit or EC card
- CaterCards can be purchased daily from 07:00 to 14:00 at the coffee bar in the Park Casino
- The price is currently € 10.00, including coding and initialization.
- Please note that if your card is lost/blocked, any remaining credit **will not** be refunded.
- If you card is defective, the stored credit **can** be transferred.

**When you purchase a
CaterCard, you will receive
a free coffee as a welcome
gift!**



How will the curriculum/schedule be organized?

	mon	tue	wed	thu	fri
8:00 9:30	■		■	■	
9:45 11:15	■	■	■		
11:30 13:00		■			
13:15 14:45	■	■	■		
15:00 16:30		■	■	■	
16:45 18:15		■			

- Fixed time grid is set up at OTN: Courses start from 8.00 am, 90min slots (+15 break)
- All (mandatory) courses held by ASG profs take place in presence in OTN. OTN will be the exclusive „home-base“ of BSc AS students



How will the curriculum/schedule be organized?

	mon	tue	wed	thu	fri
	1/ 2 Sem (WS/SS)	3 Sem (WS)	4 Sem (SS)		
8:00 9:30					
9:45 11:15					
11:30 13:00		optional GAR>OTN		optional OTN>GAR	
13:15 14:45					
15:00 16:30					
16:45 18:15					

- **Semesters 1-4:** One day per week/semester will be designated „GAR-day“. All remaining mandatory courses (by non-ASG staff) will be clustered on this day. → Commuting between campus GAR/OTN is not required on these days
- **Semesters 5-6:** Engineering electives have been rearranged to minimize commuting. Commuting windows were considered.
- Timetables for winter term 2025/26 will be uploaded in due time,
<https://collab.dvb.bayern/x/J9dfB>



Mobility

Public transport

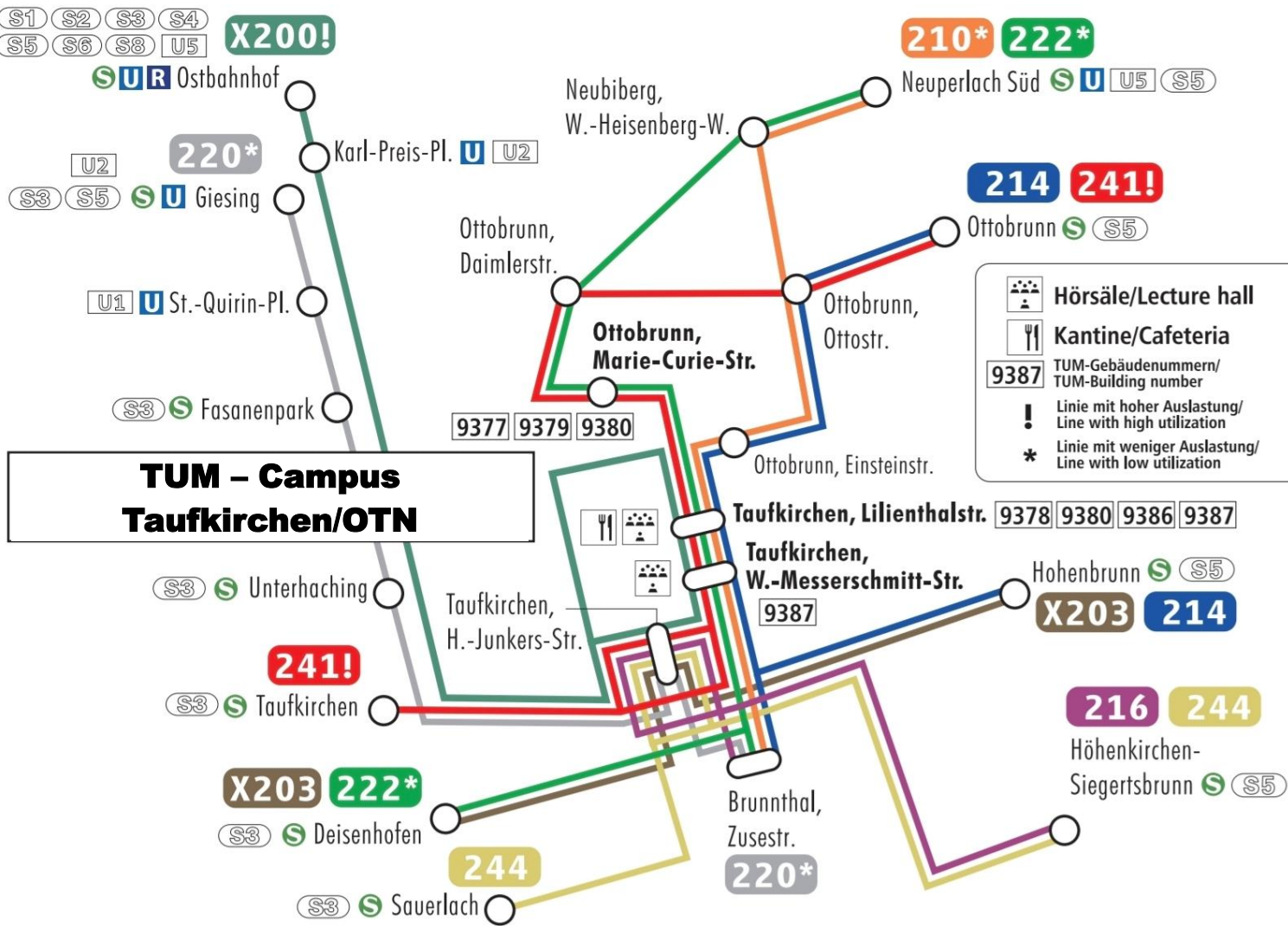

Mobility

Parking spaces

Car parking:

- 220 parking spaces will be made available
- Location: Ludwig-Bölkow-Allee/corner of Robert-Koch-Str. 11

Bicycle parking:

- 260 covered & green-roofed bicycle parking spaces under construction, but limited spaces at the start of the semester
- The bicycle parking spaces are located around the interim building
- E-charging stations
- 4 bicycle repair stations



Final questions?

Please refer to the wiki page for regular updates: [ASG Relocation wiki page](#)

Contact: campus.fslrg@ed.tum.de for any concerns regarding the new campus